

DESCRIPTION

Polymod - AP modified bituminous waterproofing APP membrane is reinforced with spun bonded polyester fabric. This combination gives the product, waterproofing qualities of bitumen combined with elasticity, excellent resistance to weathering and ease of application in roof waterproofing.

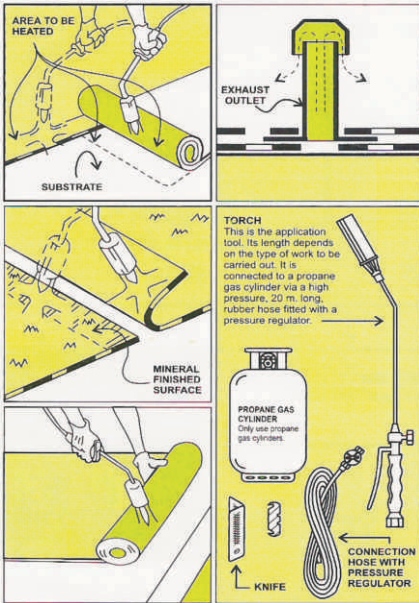

QUALITY CONTROL

In addition to stringent regular tests by in-house laboratory, periodic visits and quality control tests are performed by various outside laboratories.

STANDARDS

Polymod - AP complies with the requirements and tolerance levels of UEAtc.

INSTALLATION

TOOLS REQUIRED : Gas torch, Knife, Trowel, Measuring tape, Marking string, Gloves.

APPLICATION

Polymod - AP is installed by torch welding method, loose laid or fully bonded to substrate. When loose laid, only laps are bonded together. This can also be installed using hot blown bitumen in the conventional manner.

USES

Polymod - AP is a general purpose waterproofing membrane and is excellent in single or multilayer systems both for above grade and below grade application.

OUTSTANDING FEATURES

- Excellent cold weather resistance.
- Good elongation and recovery,
- Rot proof.
- High breaking strength and tear resistance.
- Very good puncture resistance.
- Highly resistant to substrate movement.

GENERAL DATA

Nominal roll Dimension	: 10 m x 1 m
Nominal thickness	: 3, 4, 5 mm
Reinforcement	: Isotropic, Superior quality, Polyester mat.
Finish	: Black finish

TECHNICAL DATA

Sr.No.	Property	Typical Value	Test Method
	Polymod AP		
1	Reinforcement	Polyester	
2	Softening Point °C	> 145	ASTM D 36
3	Penetration @ 25°C	15	ASTM D 5
4	Tensile strength, L/T, N/5 CM @ 23°C	650/500	ASTM D 5147
5	Elongation/T % @ 23°C	35/40	ASTM D 5147
6	Tensile tear strength L/T, N	400/250	ASTM D 5147
7	Heat Resistance @ 80°C	No Flow	ASTM D 5147
8	Cold Flexibility °C	0-(+5)	ASTM D 5147
9	Lap Joint strength L/T, N/5 CM @ 23°C	650/500	EN-12317, UNI 8202/30

NOTE : The information in this Technical Sheet is given to the best of our knowledge based on laboratory tests and practical experience. However, as the product is often used under conditions beyond our control, we cannot guarantee anything but the product itself.

IMPORTANT NOTICE

All statements, technical information and recommendations contained herein are based on reliable tests. However, the accuracy or completeness of these are not guaranteed.